



The Display Shield: Sizes 19-29" and 30-32"

Owner's Manual

Frequently Asked Questions

Assembly Instructions

Warranty Information

Manufacturer: Protective Enclosures Company

277 Douglas Avenue, Suite 1012

Altamonte Springs, Fl. 32714

1-800-331-2628

info@protectiveenclosures.com

www.thedisplayshield.com

Save this assembly manual for future reference in the event that you need to order replacement parts.



FREQUENTLY ASKED QUESTIONS

WHAT KIND OF MATERIALS ARE THE DISPLAY SHIELDS MADE OUT OF?

We researched and tested scores of materials (metals, coated wood/synthetic wood products, fiberglass, and many plastics) until we found the perfect solution. The Display Shield® outdoor weatherproof and water-resistant display enclosure is crafted from premium, flexible materials because of their strong, water-resistant, scratch-resistant, and UV-resistant properties. The housing of The Display Shield® is made from HMWPE or High Molecular Weight Polyethylene. The front panel is made from industry leading ultra-clear Lexan® polycarbonate.

HOW ARE YOUR DISPLAY COVERS MADE?

The Display Shield® outdoor digital signage enclosure is handcrafted in the U.S.A. in award winning manufacturing and assembly facilities. All materials are water and UV-resistant so they will protect your TV or display from the elements.

IS THERE A BEST PRACTICE FOR PLACEMENT OF THE DISPLAY SHIELD?

Yes, please see [“BEST OUTDOOR PRACTICES”](#) after Step 11 of these instructions.

HOW DO I CLEAN MY DISPLAY COVER?

Your outdoor display cover will look its best when kept clean. The back housing can be cleaned with a mild soap and water. However, the front panel is a special material, which will look best if you use one of our APPROVED CLEANING PRODUCTS listed in your owner’s manual in the [“CLEANING INSTRUCTIONS”](#) section.

WILL THE OUTDOOR MONITOR COVER WORK WITH DIFFERENT KINDS OF WALL MOUNTS?

Yes, The Display Shield® is engineered to be “universal” and is able to be used with all “standard” VESA mounting systems that will fit your TV. You can follow the provided instructions in order to drill into the back of the unit to fit your mount and configuration. This not only lets our patented The Display Shield® be “universal,” but also allows for the minimum number of holes or moisture entry points.

DO I NEED TO MEASURE MY DISPLAY?

Yes, measuring is VERY important, especially if you plan to use a larger display than our advertised primary sizes. Measure the dimensions of your monitor and compare with the inside dimensions of the enclosure to make sure it fits before you drill it. The Display Shield® is manufactured to fit:

HORIZONTAL UNITS:

DIMENSIONS 19-29"

FITS MOST 19" TO 29" DISPLAYS

MAX INTERIOR DIMENSIONS: 27.75"W X 19.75"H X 4.75"D

EXTERIOR DIMENSIONS: 32.25"W X 23.75"H X 6.25"D

WEIGHT: 19 LBS

DIMENSIONS 30-32"

FITS MOST 30" TO 32" DISPLAYS

MAX INTERIOR DIMENSIONS: 29.5"W X 18"H X 3.80"D

EXTERIOR DIMENSIONS: 34.25"W X 21.9"H X 4.75"D

WEIGHT: 24 LBS

VERTICAL UNITS:

DIMENSIONS 19-29"

FITS MOST 19" TO 29" DISPLAYS

MAX INTERIOR DIMENSIONS: 19.75"W X 27.75"H X 4.75"D

EXTERIOR DIMENSIONS: 23.75"W X 32.25"H X 6.25"D

WEIGHT: 19 LBS

DIMENSIONS 30-32"

FITS MOST 30" TO 32" DISPLAYS

MAX INTERIOR DIMENSIONS: 18"W X 29.5"H X 3.80"D

EXTERIOR DIMENSIONS: 21.9"W X 34.25"H X 4.75"D

WEIGHT: 24 LBS

Helpful Tips:

- Please be advised that the seal around the back housing will settle over time and you may need to apply force to close and line up the torx screws on the unit for 2 to 4 weeks. After mounting the enclosure, it may be necessary when opening and closing the unit to continue to align the threaded screws into the front panel until the unit completely settles. This “alignment” system is integral to the structural rigidity and water-tight sealing of The Display Shield®.
- If the back of The Display Shield® is drilled incorrectly, it is essential that the incorrect hole(s) be repaired. As a courtesy to our customers, Protective Enclosures Company will provide rubber plugs to seal the holes. Please call our customer service department at 1-800-331-2628.
- Use only the approved cleaning products (sold on our website) to clean the enclosure. Regular household products may cause streaking and reduction in optical clarity.
- When opening the front panel, the screws can be stored in the small black drawstring bag that is provided with the enclosure.

INSTALLATION INSTRUCTION TIPS - PLEASE READ

Thank you for purchasing The Display Shield®. Please read the following before starting the installation process.

The Display Shield® is designed to be used in conjunction with a TV wall mount, ceiling mount or any other mount using a VESA standardized mounting pattern (sold separately). Upon successful installation, The Display Shield® should be “sandwiched” between the back of the display and the mount.

You will need to unscrew the black threaded bolts from the front panel to open The Display Shield.

BEST OUTDOOR MOUNTING PRACTICES

If you are mounting your unit in an outdoor environment, we have come up with some best practices to reduce the glare and to give you the best viewing of your TV or monitor.

- Purchasing an enclosure with anti-glare or installing our anti-glare front panel will reduce the glare to an extent, but does not eliminate it.
- Mount The Display Shield® in an area that does not get direct sun if possible.
- If mounting in direct sun or in an area that gets a lot of sun, it is best if you have some type of backdrop in front of The Display Shield®. E.g., if you can mount the enclosure where there is a wall in front of it, trees, bushes or any other darker objects, it will help with reflection.
- Use a tilting and swiveling mount as you may be able to angle the enclosure in different directions to reduce the amount of glare or reflection while watching.
- Depending on your monitor’s options, change the picture mode (in the settings menu) to dynamic and/or adjust the contrast, brightness, sharpness and color.

TOOLS REQUIRED FOR INSTALLATION

These are the tools that are generally required for assembly of our products. These tools are not included with the product purchase, nor included in the box. You will need to use the hardware from a separately sold TV wall or ceiling mount.

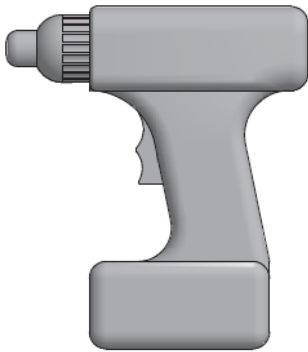

Cordless Drill or Electric Drill



5/32" or 4 mm, 3/16" or 5 mm, 1/4" or 6 mm, & 5/16" or 8 mm Drill Bit

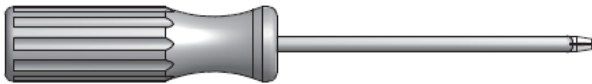

Phillips Screw Driver



Flashlight

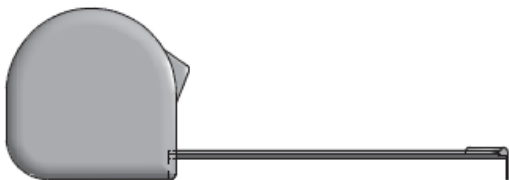

Tape Measure



Utility Knife

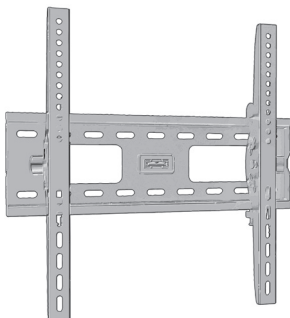

Separately Sold Mount (You Will Need Hardware from Separately Sold Mount During Installation)



An Adult w/ an Adult Helper

PARTS IDENTIFICATION

Included in Box



(1) The Display Shield®
(Horizontal or Vertical)

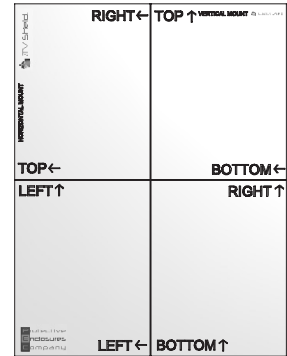

(1) Mounting Hole Template

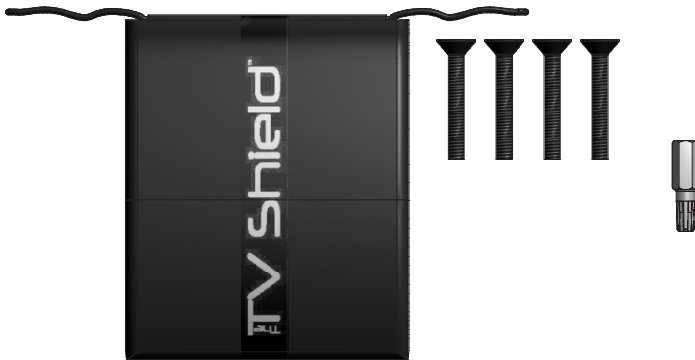

(1) Small Black Drawstring Bag

(Keep for threaded screws when removed)

Bag Contents: (1) Torx Bit and (4) Extra 10-32 x 1-1/4" Torx Screw

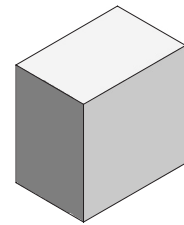

(4) Foam Blocks for Mounting



(4) - M4 - 0.18 X 0.5" METAL-BONDED WASHER - TH10020



(4) - M6 - #1 2 X 3/4" METAL-BONDED WASHER - TH10014



(4) - M5 - #1 0 X 5/8" METAL-BONDED WASHER - TH10013

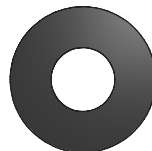

(4) - M8 - 5/16" X 3/4" METAL-BONDED WASHER - TH10015

(2) Vent Caps



Fan Filter and Cover



(1) - T-25 TORX WRENCH - AH774

STEP 1

****Read all of the assembly tips for each step thoroughly. The written tips may include important information that is not shown in the illustrations.**

1. Remove the torx screws, as shown in the diagram.

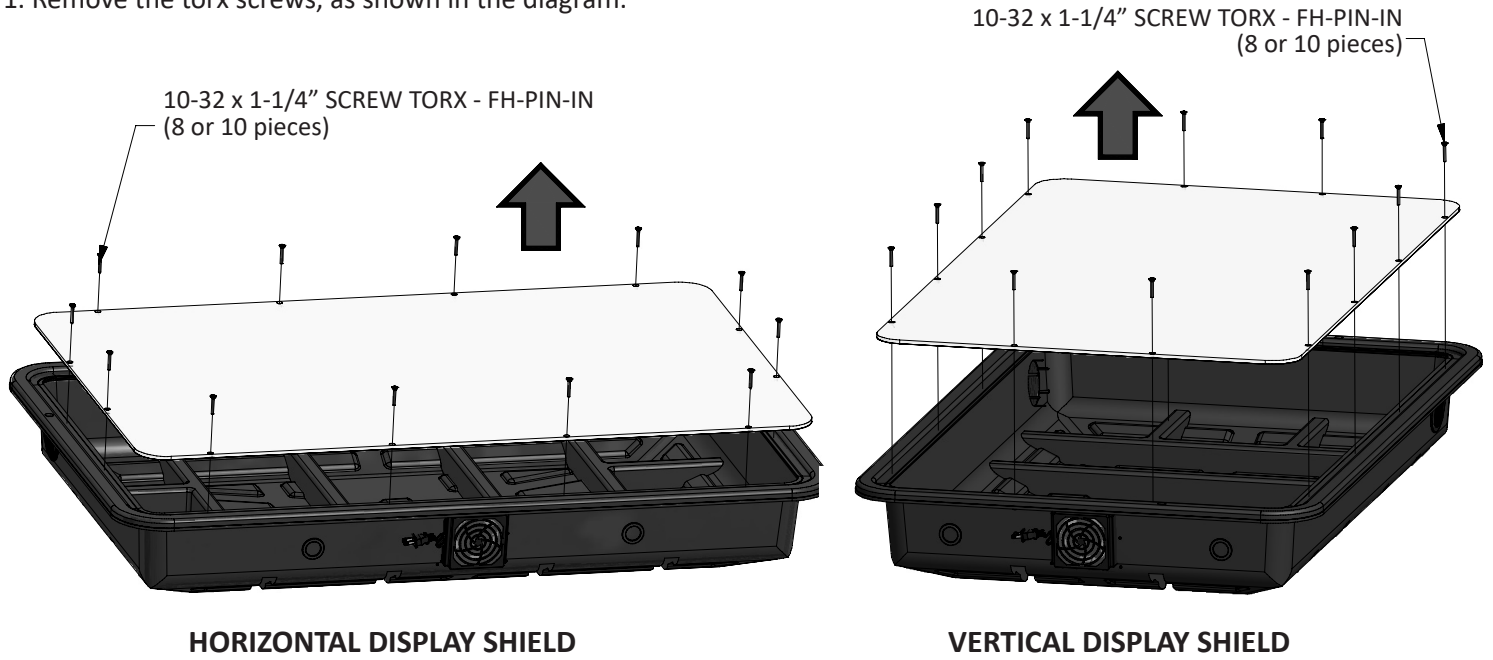

STEP 2

1. Remove the bottom grommets and make vertical and horizontal cuts, as shown below.

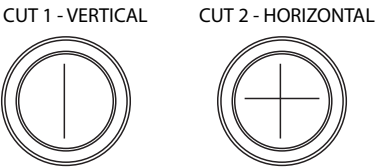
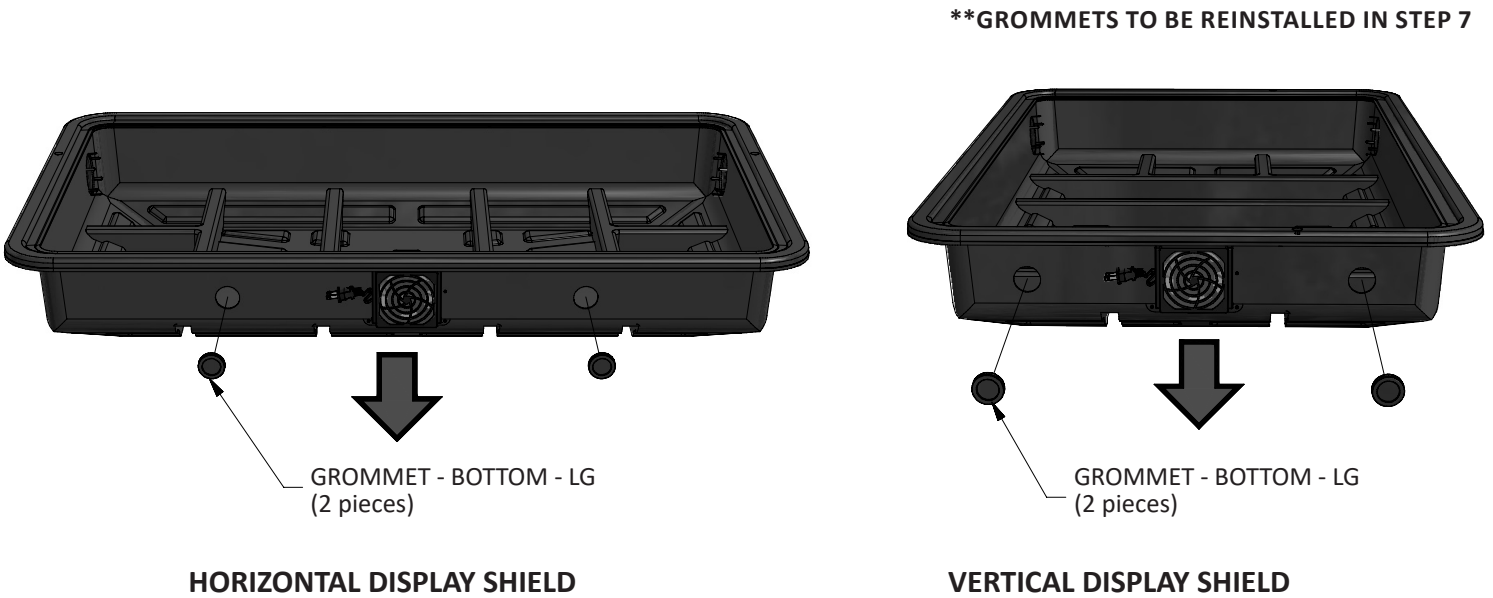

NOTE: BE SURE TO CUT ALL THE WAY THROUGH.

STEP 3

1. Arrange the foam blocks on the ground and then place the display face down on them, as shown in the diagram.
2. Pick the correct size screw that your display uses by either checking the owner's manual or by taking the provided threaded screws from your separately sold mount and screwing them into the mounting holes located on the back of your display. Remove the screw after checking as you will need this information for Step 5 below.

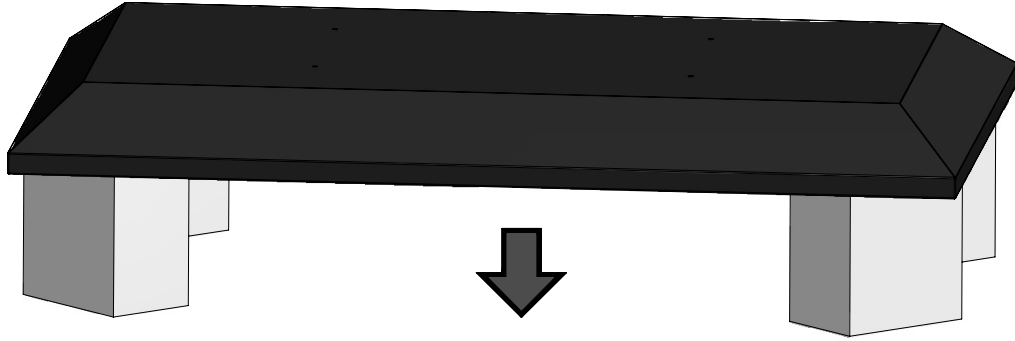

****POSITION FOAM BLOCKS UNDER THE OUTSIDE FRAME OF THE DISPLAY (NOT ON THE SCREEN).**

STEP 4

1. Locate and mark the horizontal and vertical centers on the backside of the display. Lay the provided template over the back of the display and align the template cross-hairs with the previously located horizontal and vertical centers on the display. Mark the mounting bracket hole locations on the template as shown below by punching a hole in the template.

****ACCURACY OF THE MEASUREMENTS IS HIGHLY IMPORTANT FOR PROPER ASSEMBLY OF THE UNIT.**

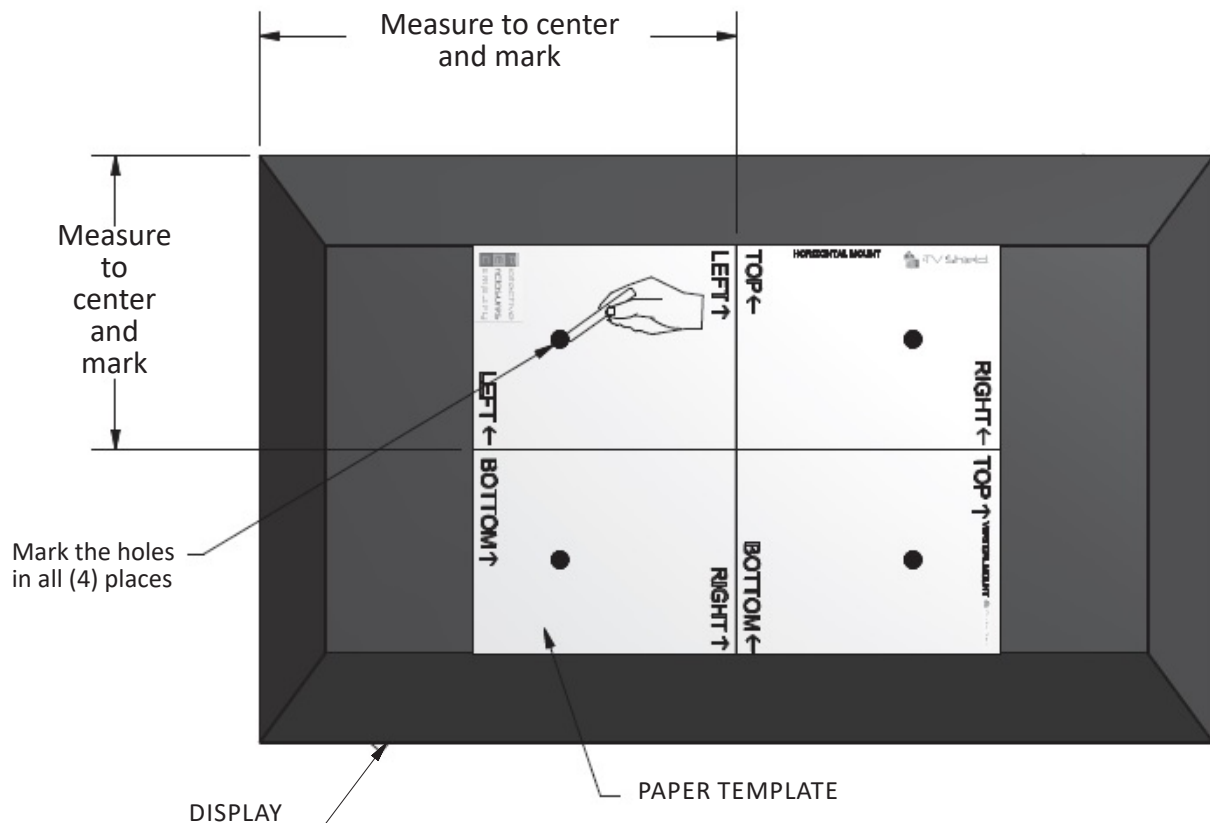

STEP 5

1. Transfer the hole pattern to the back of your The Display Shield® by aligning the cross-hairs etched into the surface of The Display Shield® with the cross-hairs on the template.

****ACCURACY OF THE MEASUREMENTS IS HIGHLY IMPORTANT FOR PROPER ASSEMBLY OF THE UNIT.**

2. Drill holes in the back of The Display Shield® at the location marked on the template using the drilling schedule below:

| Drilling Schedule | |
|-------------------|---------------|
| Fastener Size: | Drilling Bit: |
| M4 | 5/23" or 4 mm |
| M5 | 3/16" or 5 mm |
| M6 | 1/4" or 6 mm |
| M8 | 5/16" or 8 mm |

Note: Incorrectly drilled holes can be plugged using the P/N (AH782 Rubber Hole Plug). The hole diameter must be at least 5/16" or 8 mm.



If you are using the separately sold spacers for the 19-29" or 30-32" unit, please refer to the spacer kit instructions before moving on to step 6.

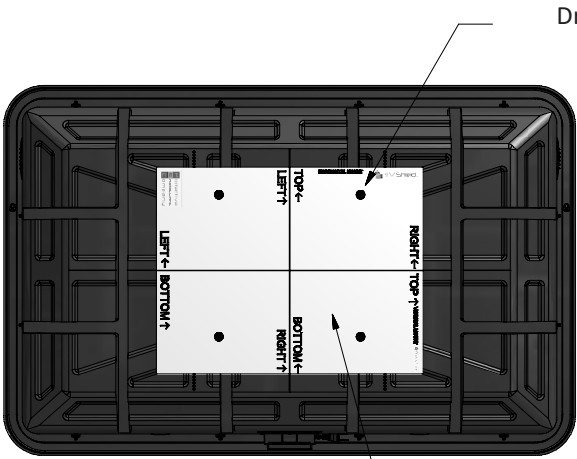

PAPER TEMPLATE

HORIZONTAL DISPLAY SHIELD

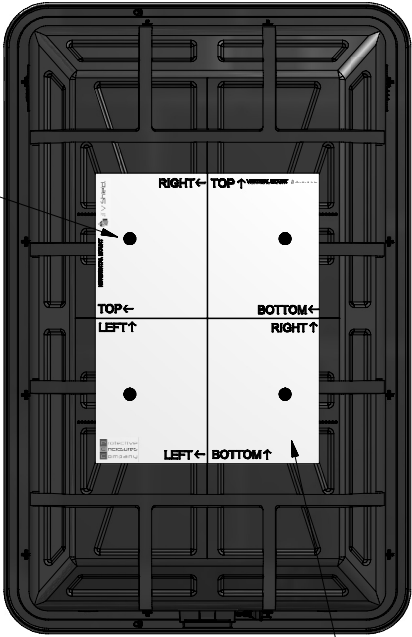

PAPER TEMPLATE

VERTICAL DISPLAY SHIELD

STEP 6

1. Install the power cord and any HDMI/Coax Cable/Component Cables needed into the correct “port(s)” on the monitor.
2. Pull all the cords and wires through the opening(s) where you removed the grommets and reinstall the grommets around the cords.
3. Place The Display Shield® directly over the display (and foam blocks) and align the previously drilled holes by looking through the drilled hole and lining them up. Using a flashlight in this step may be helpful.

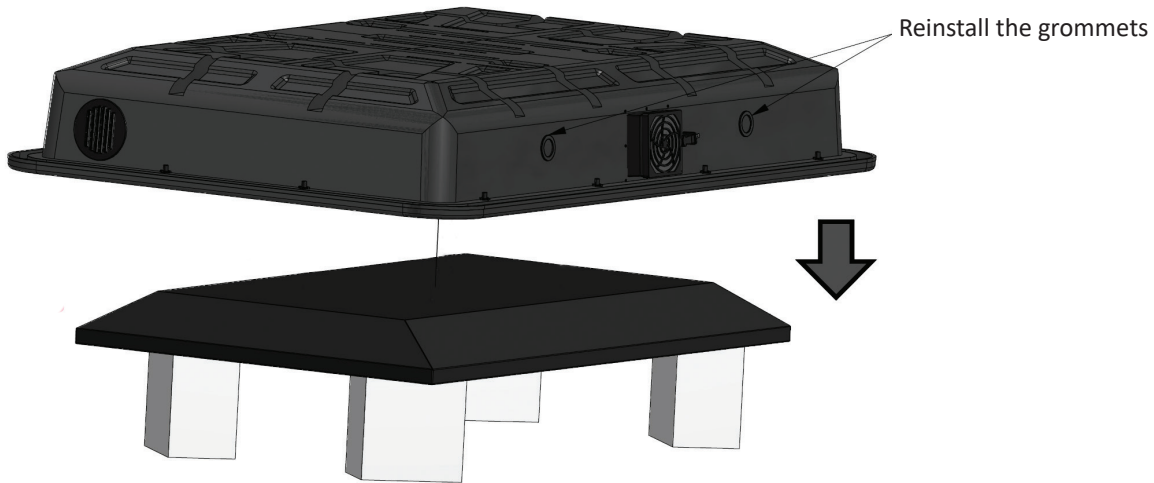

STEP 7

1. Install the mounting screws provided with your separately sold mount. You will run the screws through the mounting bracket, through the metal bonded washer, through The Display Shield® and into your monitor's mounting holes (tighten accordingly).

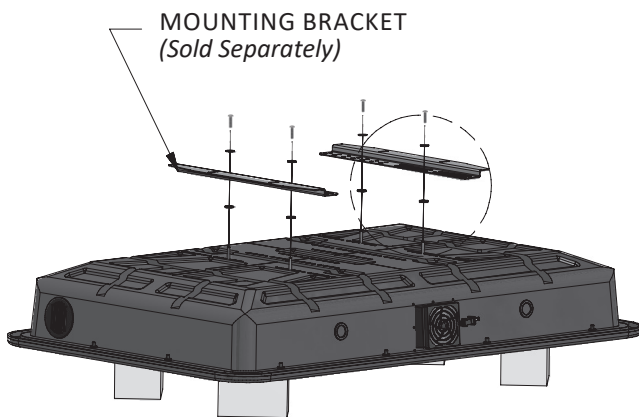
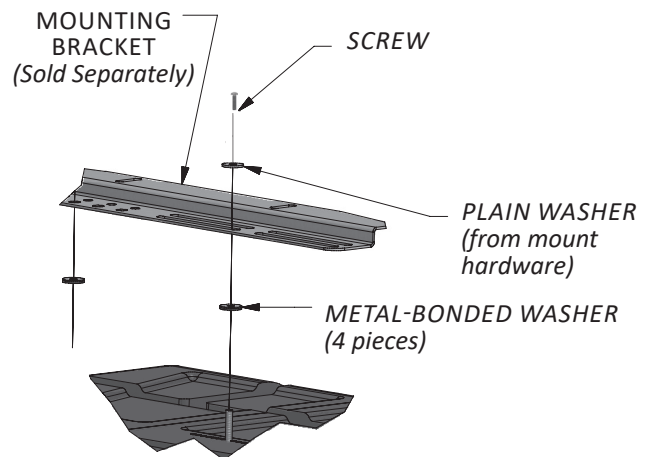

HORIZONTAL DISPLAY SHIELD

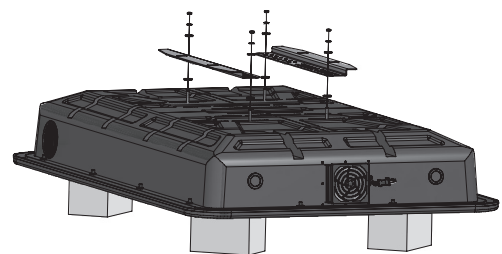

VERTICAL DISPLAY SHIELD

STEP 8

1. Remove the protective covering from both sides of the lens, as shown in the diagram.

Note: As a precaution, wash your hands and have a clean work area before you remove the protective covering. This will avoid any possible scratching of the lens that may occur during the wall mounting procedure. Also, it is advised to wipe clean the inside of the shield before securing.

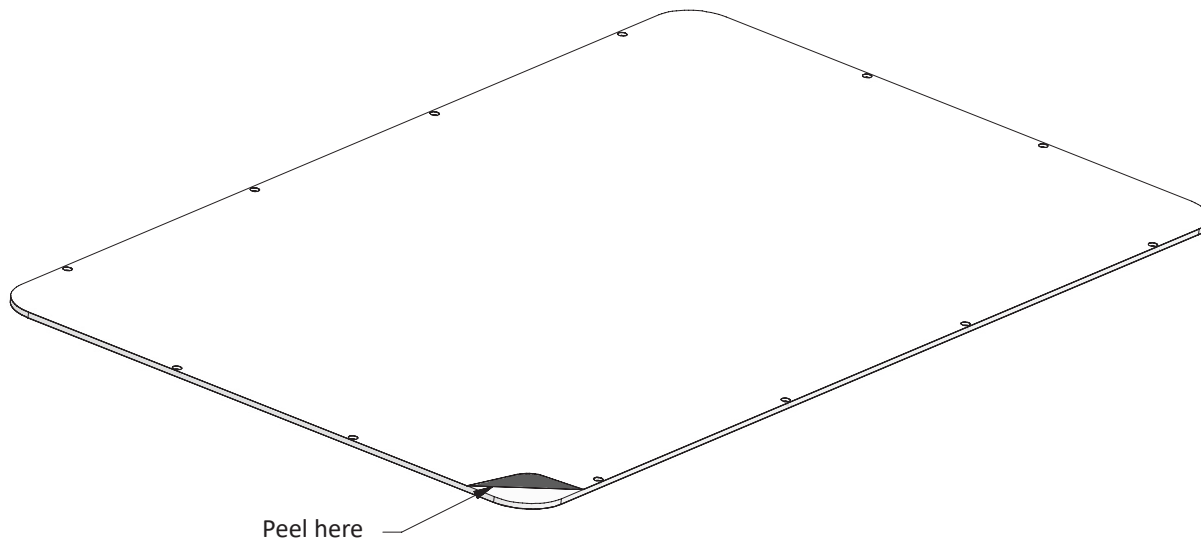

STEP 9

1. Replace the cover and torx screws as shown in the image.

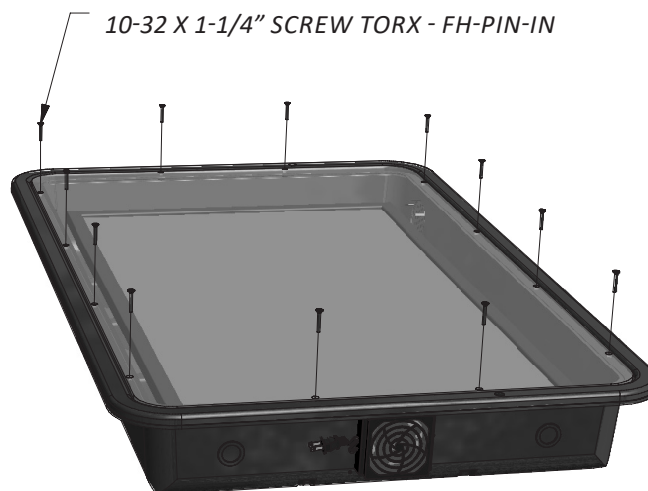

VERTICAL DISPLAY SHIELD

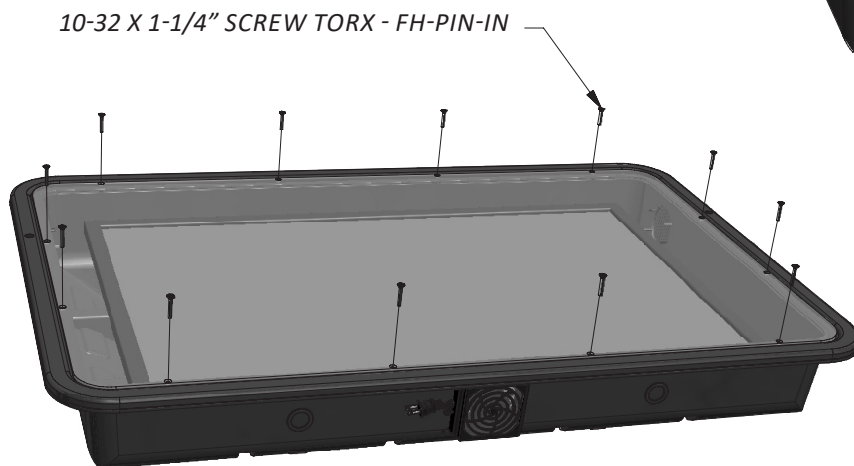

HORIZONTAL DISPLAY SHIELD

STEP 10

1. Please install the included fan filter if unit was purchased with a fan. Place the foam filter inside of the filter cover and snap it on to the exterior of the fan located at the bottom of your enclosure.
2. Installation of vent caps is only recommended for situations like wash downs and to cap the vents in cold environments to hold in heat. Do not use the cap on the vent in extreme hot environments as it will block heat exhaust.

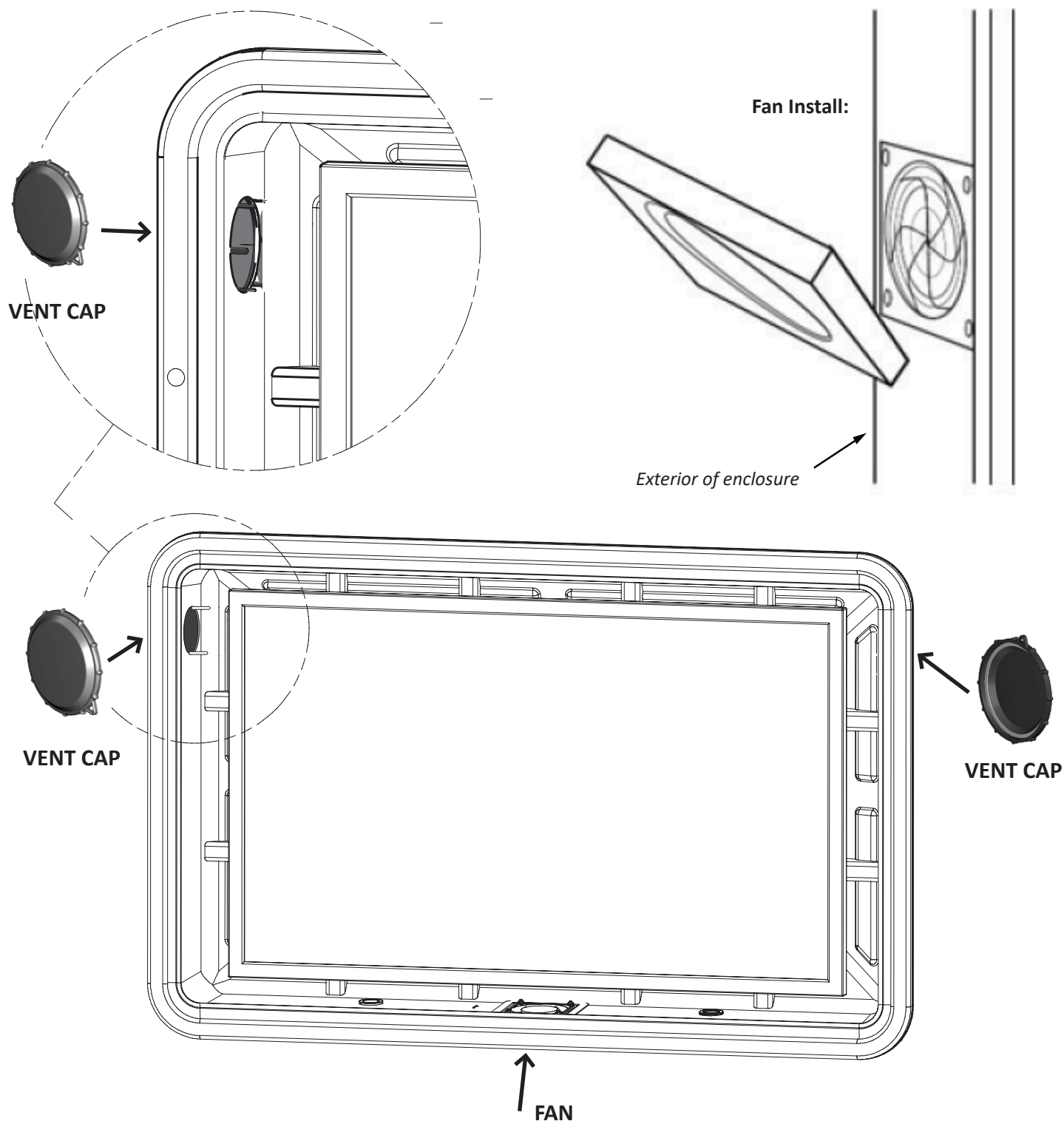

STEP 11

1. Mount the display, enclosed within The Display Shield® as one unit, according to the TV mount instructions provided with your mount (sold separately).

CLEANING INSTRUCTIONS

Polycarbonate:

When the polycarbonate sheet is first installed, the glazing compound and masking paper adhesive can be easily removed by applying naphtha (VM and P) or kerosene with a soft cloth, followed immediately with a thorough soap and water cleaning (DO NOT USE GASOLINE). Adherence to regular and proper cleaning procedures is recommended to preserve the appearance of the unit.

Washing to Minimize Scratching:

Wash the polycarbonate sheet with a mild soap or detergent and lukewarm water, using a clean sponge or a soft cloth. Rinse the panel well with clean water. Dry the product thoroughly with a chamois or moist cellulose sponge to prevent water spots. Do not scrub, use brushes or apply abrasives on these products. Splashes, grease and smeared glazing compounds can be removed easily before drying by rubbing the shield lightly with a good grade of naphtha or isopropyl alcohol. Follow the alcohol rub with a mild detergent wash using warm water and end with a clean water rinsing.

Minimize Hairline Scratches:

Scratches and minor abrasions can be minimized by using a mild automotive polish. Three such products that tend to polish and fill scratches are Johnson Paste Wax, Novus Plastic Polish #1 and #2, Novus, Inc., Minneapolis, MN and Mirror Glaze plastic polish (MG M10) Mirror Bright Polish Co., Pasadena, CA. It is suggested that a test be conducted on a sample of the polycarbonate sheet with the product selected and that the polish manufacturer's instructions be followed.

- DO NOT use abrasive or highly alkaline cleaners on the polycarbonate.
- DO NOT scrape the polycarbonate sheet with squeegees, razor blades or other sharp instruments.
- DO NOT ever use benzene, gasoline, acetone or carbon tetrachloride on the polycarbonate sheets.
- DO NOT clean the polycarbonate sheets in the hot sun or on very hot days.

Compatible Cleaners for Polycarbonate Plastic:

The following cleaning agents have been found to be compatible with polycarbonate (the manufacturer's instructions should be followed):

- The Display Shield® recommended cleaners (found on our website at www.thedisplaysield.com)
- VM and P grade Naphtha Joy™ (Proctor and Gamble)
- Palmolive Liquid™ (Colgate Palmolive)

Cleaners for Graffiti Removal:

- Butyl Cellosolve (for removal of paints, marking pens, lipstick, etc.)
- Masking tape, adhesive tape or lint removal tools (work well for lifting off old weathered paints)
- Kerosene, naphtha, or petroleum spirits (generally effective for removing labels, stickers, etc)
Note: When the solvent will not penetrate the sticker material, apply heat (hair dryer) to soften the adhesive and promote removal (GASOLINE SHOULD NOT BE USED).

Job Site Precautions:

New construction and renovations frequently require that the glazing and surrounding sash and wall finish be cleaned of any excess mortar, paint, sealant, primers or other construction compounds. Only recommended cleaners should be used to clean the polycarbonate sheets. Contact with harsh solvents such as methyl ethyl ketone (MEK) or muriatic acid can result in surface degradation and possible crazing of the polycarbonate.

BEST OUTDOOR MOUNTING PRACTICES

If you are mounting your unit in an outdoor environment, we have come up with some best practices to reduce the glare and to give you the best viewing of your TV or monitor.

- Purchasing an enclosure with anti-glare or installing our anti-glare front panel will reduce the glare to an extent, but does not eliminate it.
- Mount The Display Shield® in an area that does not get direct sun if possible.
- If mounting in direct sun or in an area that gets a lot of sun, it is best if you have some type of backdrop in front of The Display Shield®. E.g., if you can mount the enclosure where there is a wall in front of it, trees, bushes or any other darker objects, it will help with reflection.
- Use a tilting and swiveling mount as you may be able to angle the enclosure in different directions to reduce the amount of glare or reflection while watching.
- Depending on your monitor's options, change the picture mode (in the settings menu) to dynamic and/or adjust the contrast, brightness, sharpness and color.



The Display Shield® Limited Product Warranty

This limited warranty is provided by Protective Enclosures Company, LLC for The Display Shield® product(s) identified by the purchaser's registration as indicated below. This limited warranty is between Protective Enclosures Company, LLC and the registered purchaser of the product. There are no other warranties, express or implied, except as required by law, including warranties of merchantability and fitness for a particular purpose, that are provided for herein; however, all such implied warranties, if any, are limited to the duration of this specific limited product warranty. Some states do not allow limitations on how long an implied warranty lasts, so the above limitations may not apply to you.

The Display Shield® Limited Product Warranty:

7-Year Limited Warranty on the high molecular weight polyethylene plastic housing against cracking and breaking with normal consumer use.

5-Year Limited Warranty on the polycarbonate front shield (cover/panel/window) against cracking or breaking with normal consumer use. This warranty does not cover any scratches or damaged caused by abuse or normal use, it only covers against discoloring, cracking, yellowing or breaking of the polycarbonate front cover.

3-Year Limited Warranty on product failure or quality of workmanship and on all other components against any manufactures defects.

This is a limited warranty, subject to the conditions, limitations and exclusions identified herein. Protective Enclosures Company, LLC warrants to the original purchaser of the registered or identified product for a period of time listed above, from the date of purchase, that the product shall be free of defects in materials, and workmanship, and subject to the limitations set forth below; Protective Enclosures Company, LLC will repair or replace, at its option, any defective unit. Protective Enclosures Company, LLC hereby warrants to the original retail purchaser of this product that should this product or any part thereof, under normal use and conditions, prove to be defective in material or workmanship within one (1) year from the date of the original purchase, such defect(s) will be repaired or replaced with a reconditioned product (Protective Enclosures Company LLC's option) without charge for parts and repair labor. Purchaser must return the product to Protective Enclosures Company, LLC, (return receipt requested) or by other means that confirms delivery and Protective Enclosures Company, LLC shall make the said repairs or replacement within 60 days of receipt. In some instances the product may have been discontinued and cannot be replaced, or repaired. In that instance Protective Enclosures Company, LLC shall in its discretion attempt to replace the product with a substantially similar product in a current model or design or pay the purchaser a sum for the then fair market value of the product, considering the amount of depreciation since sale, and the use of the product. This Limited Warranty is the original retail purchaser's sole remedy for any and all such defect(s).

Conditions and Limitations:

Proof of purchase is required (i.e. the sales receipt or other proof of payment).

Damage caused by accidents, abuse, misuse or modification of the product will render this warranty null and void. This warranty is applicable only to the original purchaser and is not assignable or transferable. To obtain repairs or replacement under the terms of this warranty, please contact Protective Enclosures Company, LLC at 1-800-331-2628 or visit www.protectiveenclosures.com. You will need to provide proof of purchase (dated receipt showing where the item was purchased) and the product part number in order to receive warranty service. The purchaser is required to send the product back to Protective Enclosures Company or to a designated repair center and the purchaser is responsible for all charges for shipping and handling.

This Limited Warranty does NOT cover:

1. Products which have been subject to abuse, accident, alteration, modification, tampering, negligence, misuse, theft or attempted theft, vandalism, improper installation, lack of reasonable care, unauthorized repair or service, or if the model or serial number has been altered, tampered with, defaced or removed.
2. Loss or damage caused by the use of unauthorized cleaning products or methods that damage or destroy the product.
3. Initial installation or the removal and re-installation of the product.
4. Cosmetic damage, an act of God, or natural disaster.
5. Products modified or used for any purposes other than for those which the product is specifically designed.
6. Damage that occurs in shipment (the third party shipping service is responsible for any shipping damages).

The company reserves the right to remedy any minor defects in defective units by replacing defective, inoperable or missing parts rather than offering a refund or exchange.

Protective Enclosures Company, LLC, or any subsidiaries, shall not be liable, under any circumstances, for incidental, indirect, special, and consequential or multiple damages as a result of the sale or use of this The Display Shield® product. Some states and countries do not allow the exclusion or limitation of incidental or consequential damages, so the above limitations or exclusions may not apply to you.

THE EXTENT OF PROTECTIVE ENCLOSURES COMPANY, LLC'S LIABILITY UNDER THIS WARRANTY IS LIMITED AS PROVIDED ABOVE AND, IN NO EVENT, SHALL THE LIABILITY OF PROTECTIVE ENCLOSURES COMPANY, LLC EXCEED THE PURCHASE PRICE PAID BY THE ORIGINAL RETAIL PURCHASER FOR THE PRODUCT.

Any questions regarding this warranty should be addressed to:

Protective Enclosures Company, LLC
The TV Shield | The Display Shield
ATTN: WARRANTY DEPARTMENT
277 Douglas Avenue, Suite 1012
Altamonte Springs, Fl. 32714
USA
800-331-2628 Toll Free

THIS WARRANTY IS IN LIEU OF ALL OTHER EXPRESS WARRANTIES OR LIABILITIES. ANY IMPLIED WARRANTIES, INCLUDING ANY IMPLIED WARRANTY OF MERCHANTABILITY, SHALL BE LIMITED TO THE DURATION OF THIS WRITTEN WARRANTY. IN NO EVENT SHALL PROTECTIVE ENCLOSURES COMPANY, LLC, OR ANY SUBSIDIARY, OWNER, OR PARTNER BE LIABLE FOR ANY CONSEQUENTIAL OR INCIDENTAL DAMAGES FOR BREACH OF THIS OR ANY OTHER WARRANTY EXPRESS OR IMPLIED WHATSOEVER.

No person or representative is authorized to assume for Protective Enclosures Company, LLC any liability other than expressed herein in connection with the sale of this product. Some jurisdictions do not allow limitations on how long an implied warranty lasts or the exclusion or limitation of incidental or consequential damages so the above limitations or exclusions may not apply to you. This warranty gives you specific legal rights and you may also have other rights, which vary from jurisdiction to jurisdiction.

REFUND/RETURN POLICY

We offer a 30-Day Money Back Guarantee on all unopened, unused and/or undamaged units. The unit must be unaltered and it must have the protective covering(s) on the front panel and be undamaged and in original new condition. A 10% restocking fee applies and all refunds will be minus the actual shipping charges to and from Protective Enclosures Company.

Upon acceptance and processing of the return/refund, all funds will be returned to the original method of payment (minus all fees).

After 30 days, and up to 90 days from the date of the purchase, if you are not happy with The Display Shield® enclosure, and have opened it, you can return it for a refund, less actual shipping charges to and from Protective Enclosures Company. The unit(s) must have protective covering(s) on the front panel and be undamaged and in original new condition. Due to the nature, size and logistics in inventory management and distribution, our restocking fee after 30 days, and up to 90 days, is 25% and applies to all opened / new non defective The Display Shield® enclosures.

All refunds will be returned to the original method of payment minus all fees and will be processed on our end within 10 business days (excluding weekends and holidays).

Protective Enclosures Company DOES NOT accept returns on units that have been drilled, scratched, damaged, abused or have had the protective coverings taken off of the front panel, as they cannot be resold as new products. If you have made a mistake when drilling or mounting The Display Shield®, although we will not accept a return within terms, we do have several remedies available to you to help you repair the “damaged” area and still be able to use your unit. Please call our customer service department for help at 1-800-331-2628 which is toll free, anytime during normal business hours which are between 9:30am and 6:00pm Eastern Standard Time, Monday through Friday.

LIMITED WARRANTY

Protective Enclosures Company, LLC – The Display Shield® Limited Warranty – Valid in the United States and Canada

Protective Enclosures Company, LLC
The TV Shield | The Display Shield
277 Douglas Avenue, Suite 1012
Altamonte Springs, Fl. 32714
800-331-2628 Toll Free

Specifications are subject to change without notice.
All trademarks are the property of their respective owners.
www.protectiveenclosures.com



Protective Enclosures Company
277 Douglas Avenue, Suite 1012
Altamonte Springs, Fl. 32714
1-800-331-2628

Specifications are subject to change without notice.
All trademarks are the property of their respective owners.

www.thedisplayshield.com

Accessories

Accessories for PEC's Outdoor TV & Display Enclosures



For Hot or Cold Environments with Moisture, Dust & More...

CLIMATE CONTROL

Anti-Glare Front Shield



**Reduces Sun Glare
& Improves Clarity**

| Models: | Models: |
|--------------------|-------------------|
| TVS1929FSAG | DS1929FSAG |
| TVS3032FSAG | DS3032FSAG |
| TVS3643FSAG | DS3643FSAG |
| TVS4450FSAG | DS4450FSAG |
| TVS5255FSAG | DS5255FSAG |
| TVS6065FSAG | DS6065FSAG |

Sun rays create a significant glare challenge for outdoor TV solutions. This means that light reflecting off of a TV or display can easily hinder viewing clarity. PEC has developed an innovative anti-glare coating process for shatter-resistant polycarbonate front panels which eliminates 90% of glare. PEC's scratch resistant anti-glare shields enable much higher quality viewing for TVs and digital monitors placed in direct sun environments.

Dust Cover



*Add a Layer of
Protection from
Dust, Insects or to
Simply Discourage
Tampering*

This quick install cover is ideal for those times when you are not going to use your TV or The Display Shield.

1. Material: waterproof/dustproof premium fabric
2. Elastic fit for quick installation and removal
3. Custom designed to fit your PEC enclosure

Heater



This fan forced heater keeps the interior temperature of a unit between 41° F and 47° F (above freezing). It has an in-line thermostat and requires at least 1 1/2" of space between the bottom of the TV and the enclosure in order to be installed.

Moisture Control Gel Case



This Dehumidifying Silica Gel Case absorbs dampness inside the case and protects anything that can be damaged from rust, mildew, and fungus (the case size is 4" x 2" x 1/2").

Visit www.thetvshield.com for Full Product Descriptions and to Order
or Call 1-800-331-2628

CLEANERS & PROTECTANTS

Shield Cleaner / Polish / Cleaning Pad Combo Kit



Kit Includes:

1. One 8 oz. bottle of PEC Novus #1 cleaner
2. One 8 oz. bottle of PEC Novus #2 polish
3. One cleaning pad

This kit includes PEC's top recommended products for keeping enclosures clean and looking like new.

The Novus #1 cleaner gently cleans all plastics without scratching and leaves a lustrous shine that resists fogging, repels dust, and eliminates static. The cleaner also helps prevent finger marks, contains no abrasives or harsh chemicals and leaves a smooth, clean, greaseless shine.

The Novus #2 polish removes scratches, haziness, and abrasions from most plastics. Use the cleaner repeatedly to restore faded and discolored plastics. The product removes the damage instead of filling it in and buffs out quickly. After restoring, this solution seals with a coat of polish.

** Never clean polycarbonate with paper towels because they can scratch the shield!*

Polycarbonate Shield Cleaner #1 (8oz Spray)



Features:

1. Improves finger smear resistance
2. Contains no abrasives or harsh chemicals
3. Leaves a smooth, clean, greaseless shine

This solution gently cleans all plastics without scratching and leaves a lustrous shine that resists fogging, repels dust, and eliminates static.

Polycarbonate Shield Polish #2 (8oz Bottle)



Features:

1. Removes damage instead of filling it in
2. Buffs out quickly
3. After restoring, this treatment seals with a coat of polish

This polish removes scratches, haziness, and abrasions from most plastics. Use the solution repeatedly to restore faded and discolored plastics. A 2oz bottle is also available.

OUTDOOR AUDIO

Outdoor Audio Speaker Kit



Kit Includes:

1. Pair of 4" dual 3-way black 50Watt RMS/100watt max dynamic indoor & outdoor speakers
2. 20WX2 mini amplifier w/ A/C power adapter
3. RCA cable
4. 20ft high quality speaker cable
5. Self-adhesive Velcro®

This solution will provide better audio than a TV could provide and it far surpasses the sound you would have gotten, giving you the ability to have music or dynamic movie watching experiences outside. Some TVs need a converter for this kit.

4" Outdoor Dual 3-Way Speakers



Features:

1. Pair of dual black multipurpose indoor/outdoor speakers
2. 50 watts of RMS power, with 100 watts of peak power
3. 4" woofer, 25mm poly cone midrange, & 20mm piezo dome tweeter
4. Wall-mountable, UV-treated ABS enclosure; mounting brackets included
5. Each speaker measures: 8.25" x 5.25" x 5.25" (H x W x D)

These are great sounding 3-way speakers that work indoors or outdoors with 100 watt peak power handling (they can mount to the unit directly or they can mount to the wall).

Premium Digital to Analog Audio Converter



Features:

1. Converts Coaxial or Toslink signals to analog L/R audio
2. Toggle switch is used to choose Coaxial or Toslink as the input
3. Supports DTS/Dolby Digital audio source
4. Built-in Dolby/DB HD, the DTS HD, LPCM/LPCM with decoding
5. 24-bit S/PDIF incoming bit stream on left & right channels
6. Supports a full range of 32k, 44k, 1k, 48k, 64k, 88.2k, 96k, 192k
7. Power Supply: 5V DC

Some TVs need this item for the audio kit system to work. TVs that don't have RCA or 3.5mm headphone outputs need this Dolby Digital approved, UL listed converter.

Mini Stereo Amplifier (Analog Inputs)



Features:

1. 2 channel
2. 3.5 input for iPod or any other MP3/MP4 device
3. Separate bass & treble controls
4. Aluminum alloy case
5. Input power: DC 9- 14.4v 2A
6. Input impedance: 47k
7. Frequency response: 20Hz-20 kHz
8. Speaker impedance 2-8ohm
9. Harmonic distortion: <0.4%
10. SNR >80db
11. Size: 6.02" x 3.74" x 1.5"
12. Two 10ft high speaker ables

This Amp allows you to listen to music easily and includes power supply, volume control, a pair of RCA cables and an RCA Input to plug into your TV.

Call 1-800-331-2628 or Visit www.thetvshield.com to Order

Copyright © 2009-2019 Protective Enclosures Company, LLC | Made in the USA
The TV Shield®, The Display Shield® and The TV Shield Pro® and their logos are trademarks of Protective Enclosures Company